

## CONFERENCE ROOM E

The conference room E is located in the northern part of Hall 4 within the Warsaw EXPO XXI venue. Room is divided by a permanent wall, creating approx. 10 m<sup>2</sup> of separate space. A foyer on a mezzanine is located in front of Room E and offers a view on the entrance area to Hall 4.

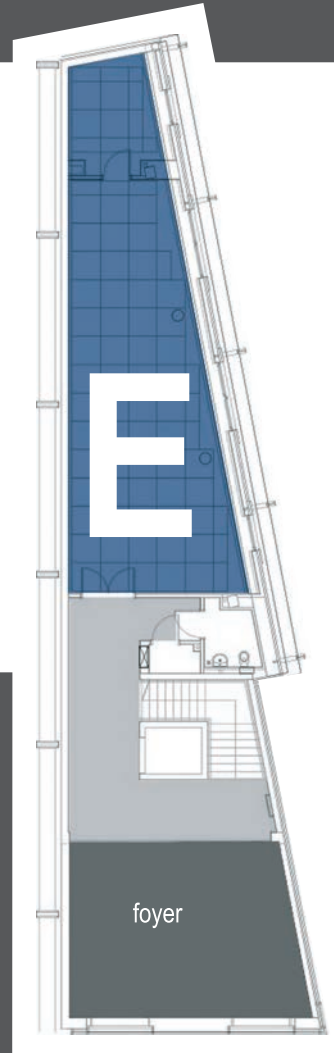

Room E - floorplan



### ROOM E specification:

shape - **trapezium-shaped**

area - **65 m<sup>2</sup> + 10 m<sup>2</sup>**

height - **3 m**

division into separate rooms - **no**

number of entrances - **1**

floor load capacity - **500 kg / m<sup>2</sup>**

#### Color Scheme:

- walls - **bright grey**
- floor - **burgundy carpet**
- ceiling - **white panels**
- **access to daylight and possibility to darken the room (blinds)**

Sockets and other connections in the conference rooms are located on the walls.

### Capacity

maximum number of occupants - 50 people

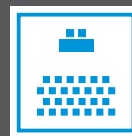

**50** people / theater arrangement



**50** people / class arrangement



**40** people / U-shaped arrangement



**50** people / reception arrangement

## SERVICES INCLUDED IN THE RENTAL PRICE

- chairs
- air conditioning and heating
- 24h security and video surveillance of the venue
- support from on-duty technical staff
- toilets and cleaning services for the entire rental period
- cleaning

Foyer, hallway:

Foyer area - **approx. 20 m<sup>2</sup>**

Color scheme:

- walls - white
- floor - grey terracotta tiles
- ceiling - white panels



### EXPO XXI WARSAW

Warszawskie Centrum EXPO XXI Sp. z o.o Prądzyńskiego 12/14, 01-222 Warszawa,  
phone number (22) 256 71 00, fax. (22) 256 71 11  
Entered into the Register of Businesses maintained by the District Court in Warsaw XII Business Department  
of the National Court Register under the number KRS: 21016 NIP: 525-21-52-338 REGON: 016026441  
The share capital: 6 306 000,00 zł

[www.expoxxi.pl](http://www.expoxxi.pl), [sales@expoxxi.pl](mailto:sales@expoxxi.pl)

EXPO XXI Warsaw is a part of the Sapphire Group