

Conference rooms in hall 4

ROOM E

Conference room E is located on the first floor of the side entrance to Hall 4 in the EXPO XXI Warsaw complex. Adjacent to the room is a space of approximately 10 square meters. In front of Room E, there is a foyer on the mezzanine level, offering a view of the main entrance hall to Hall 4.

ROOM E, specification:

- Shape – **trapeze**
- Area – **65 m² + 10 m²**
- Height – **3,29 m**
- Floor load – **500 kg/m²**

Colours:

- Walls – **white**
- Floor – **dark red carpet**
- Ceiling – **white coffers**

Windows – **daylight accessible, blinds available**

Media outlets are located on the wall.

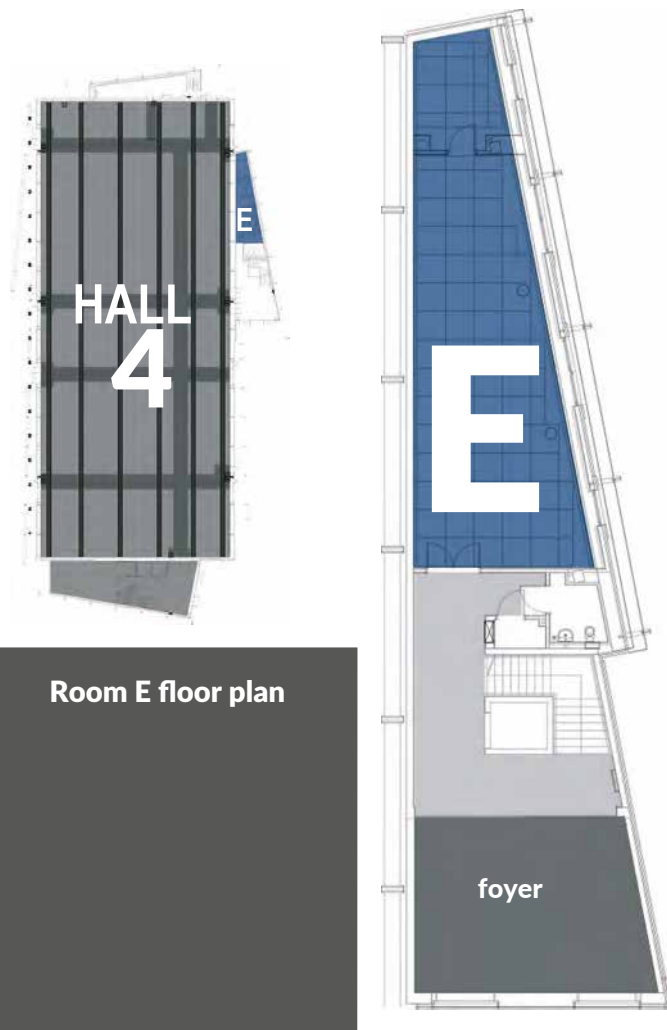

Room E floor plan

Capacity:
Max. 45 pax

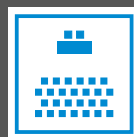

45 pax / theatre



20 pax / class room

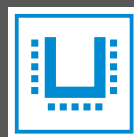

20 pax / U shape

Partners:



sales@expoxxi.pl

Warszawskie Centrum EXPO XXI Warszawa
ul. Prądzyńskiego 12/14, 01-222 Warszawa

expoxxi.pl



Services included in rent:

- Chairs
- Air conditioning and heating
- Help of technical service



Foyer, specification:

Area – **approx. 20 m²**

Colours:

- Walls – **white**
- Floor – **light grey terracotta**
- Ceiling – **white coffers**



Partners:



sales@expoxxi.pl

Warszawskie Centrum EXPO XXI Warszawa
ul. Prądyńskiego 12/14, 01-222 Warszawa



expoxxi.pl